

# BENSON POLYTECHNIC HS / DAG #11 UPDATE

# AGENDA

## BENSON POLYTECHNIC HS MODERNIZATION UPDATE

- + Schedule & Process Update
- + Budget Update
- + SHPO Update
- + Equipment & Move Out Update
- + Construction Logistics Plan
- + Groundbreaking Update
- + Design Update
  - » PISA Relocation
  - » Updated Renderings

## MARSHALL SWING SITE UPDATE

- + Schedule & Process Update

## MULTIPLE PATHWAYS TO GRADUATION BUILDING

- + Schedule & Process Update
- + Design Updates

# BENSON HS MODERNIZATION / UPDATE

# BPHS MODERNIZATION / SCHEDULE & PROCESS UPDATE

## PROJECT PROGRESS

- + 50% CD set issued February 15, 2021, submitted for Building Permit
- + 50% CD Pricing issued April 26, 2021
- + Discussion and reconciliation of 50% CD set pricing in process
- + Type II Land Use follow-up process approved April 2021 (Radio Tower Signage, Site Fencing and Courtyard Lighting)
- + Stakeholder Engagement for State Historic Preservation Office (SHPO) process on-going
- + Demolition Permit process nearly complete; Building Permit review comments pending
- + 100% CD Documents target: October 2021





# BPHS MODERNIZATION / BUDGET UPDATE

## PROJECT BUDGET STATUS / MAY 2021

- + 50% CD Pricing issued April 26, 2021
- + Discussion and reconciliation of 50% CD set pricing in process
- + Value Engineering brainstorming and vetting ongoing, path-to-budget to be established

	TOTAL COST
TARGET BUDGET (APRIL 2021):	\$216.6M
ANDERSEN 50% CD PRICING:	\$244.5M
CFI 50% CD ESTIMATE:	\$222.4M
DELTA TO OVERCOME: (ANDERSEN PRICING)	\$27.9M

## PRICING RESULTS INFLUENCED BY:

- + Market Volatility / Steep Increase in Commodities Pricing / COVID Impact
- + Bidding Climate / Timing
- + Estimate Corrections / Scope Gap
- + Design Progression / Detailing / Constructibility & Sequencing Input from Contractor
- + Changes in Scope

## NEXT STEPS:

- + Complete VE & Pricing Evaluation / Cost Reduction Process
- + Re-bid of Key Packages
- + Evaluate timing for Bidding & Purchase to obtain best material procurement outcome

# BPHS MODERNIZATION / SHPO UPDATE

- + SHPO Advisory Committee has met twice in Spring 2021 to review project / discuss SHPO Mitigation strategies
- + Draft of Memorandum of Agreement (MOA) to be reviewed at next Committee Meeting
- + Salvage items / artifacts identified and documented in preparation for storage
- + Example mitigation strategies:
  - » Retain Auditorium Bldg, Administration Bldg, Aux Gym Building
  - » Retain NE Irving St and Buckman Field facing facades of North and South shop wings
  - » Historic Facade Repair at Existing Bldgs
  - » Wood & Steel Window Restoration and Repair
  - » Retain, repair & refinish trim work and wood paneling at Main Lobby and Auditorium Lobby
  - » Portion of existing wood auditorium seating to be retained & repaired
  - » Salvage portion of existing wood gym flooring for re-use as material for learning stairs
  - » Salvage key artifacts for re-installation in modernized design (i.e. Aux Gym Speakers, Drone Plane, Propellers, Benson Bubbler, Memorial Plaques, Class Benches, etc)





# BPHS MODERNIZATION / EQUIPMENT & MOVE-OUT UPDATE

- + Existing Equipment being Auctioned or prepared for moving to Marshall Swing Site or Storage
- + Some equipment re-furbished / updated in preparation for move to Marshall
- + Salvage items / artifacts identified and documented in preparation for storage
- + Room-by-room effort to remove unwanted or un-needed items
- + Some new equipment and furniture being purchased in preparation for use at Marshall (and ultimately Benson HS)



GovDeals provides services to government agencies allowing them to sell surplus assets via the internet. Each agency has its own auction rules and may be subject to government antitrust.

**GovDeals**  
A LIQUIDITY SERVICES MARKETPLACE

Search Auctions

[Advanced Search](#)



**Pacific Hydraulic press  
Brake & Shear**

Auction Ends **2/26/21 6:28 PM ET**

Remaining **8 Days 3 Hrs**

This item is subject to an auto extension of the auction end time.

[Refresh Bid & Time](#)

Buyer's Premium **5.00%**

Starting Bid **\$300.00**

Bids **4**

High Bidder **e\*\*\*\*l**

Current Bid **\$460.00**

Bid Increment **\$10.00**

Minimum Bid **\$470.00**

[Terms and Conditions](#)

573 visitors

Make/Brand	Model
Whitney-Jensen	40-6

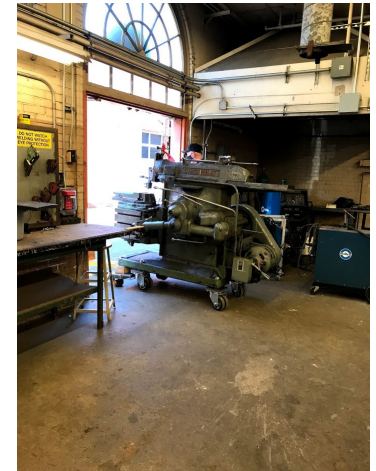

# BPHS MODERNIZATION / CONSTRUCTION LOGISTICS PLAN

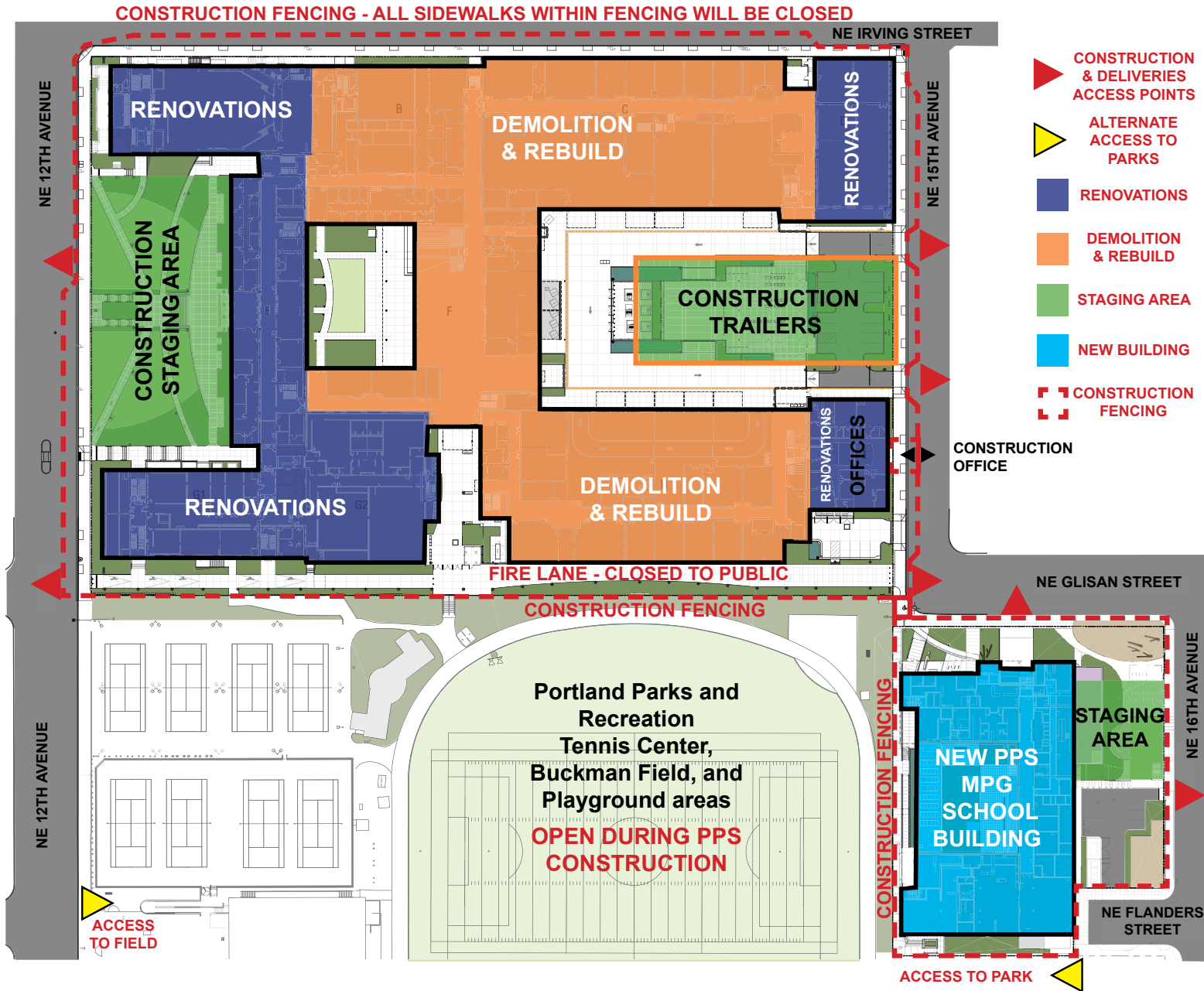



# BPHS MODERNIZATION / GROUNDBREAKING UPDATE

- + SAVE THE DATE: Benson Tech Groundbreaking - Saturday, August 7th, 10am
- + Event Details & in-person / online TBD



# BPHS MODERNIZATION / DESIGN UPDATES

## PISA RELOCATION

- + PISA will relocate elsewhere, will not be coming back to Benson HS Site
- + Allows for 4 desirable classrooms on 2nd floor of Main Building - could be used by Benson HS during day and by Virtual Scholars afterschool
- + Allows for less-desirable rooms in basement of Aux Gym Building to be used for storage

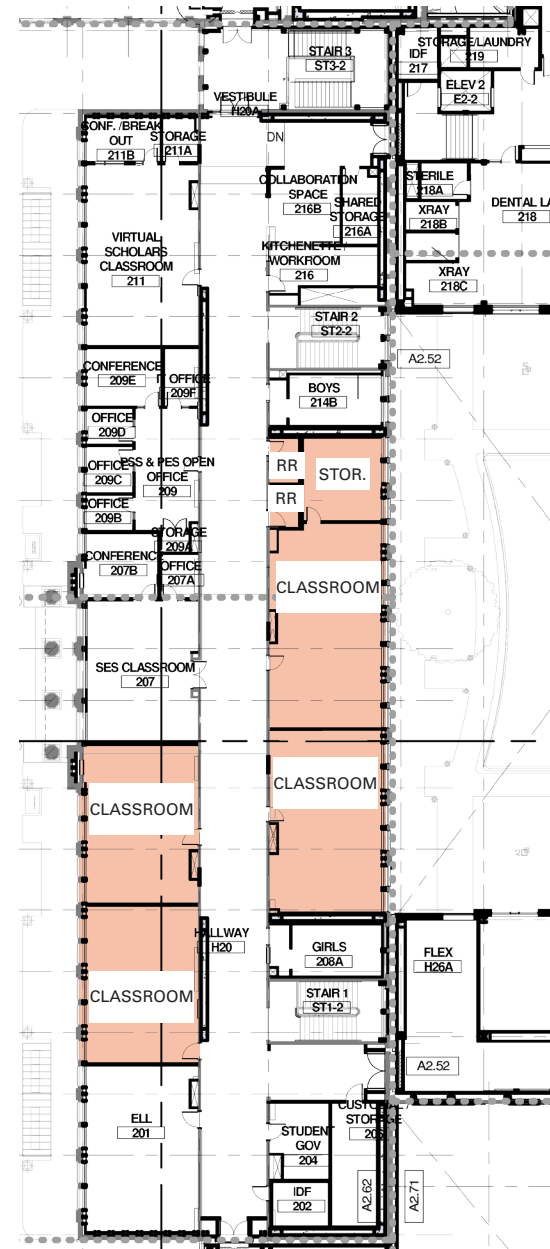

LEVEL 2



# BPHS MODERNIZATION / DESIGN UPDATES



*bassetti*  
architects

AERIAL VIEW OF WEST ENTRY COURTYARD FROM NW



# BPHS MODERNIZATION / DESIGN UPDATES



DAYTIME VIEW OF WEST ENTRY COURTYARD FROM SW



# BPHS MODERNIZATION / DESIGN UPDATES



EVENING VIEW OF WEST ENTRY COURTYARD FROM SW



# BPHS MODERNIZATION / DESIGN UPDATES



INTERIOR VIEW OF COMMONS LOOKING NORTH



# BPHS MODERNIZATION / DESIGN UPDATES



INTERIOR VIEW OF COMMONS LOOKING SOUTH

# MARSHALL SWING SITE / UPDATE

# BENSON SWING SITES PHASING PLAN

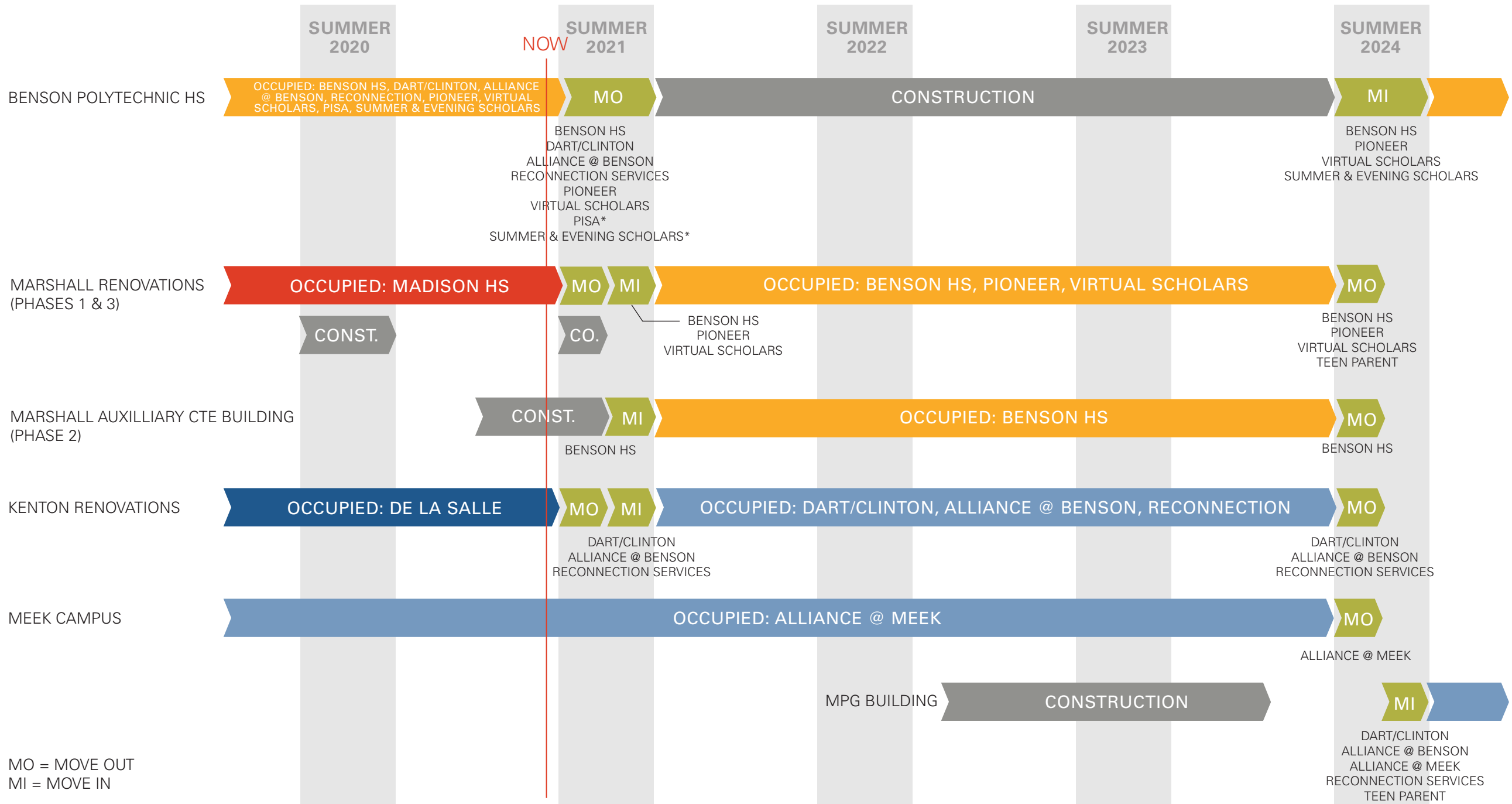

\*SUMMER AND EVENING SCHOLARS TO MOVE TO GRANT HS, AND PISA TO MOVE TO MADISON HS DURING BENSON HS CONSTRUCTION



# MARSHALL SWING SITE PROJECT UPDATES

## PROJECT PROGRESS

- + CTE Annex under construction
- + Madison HS to move out / Benson HS to move in Summer 2021

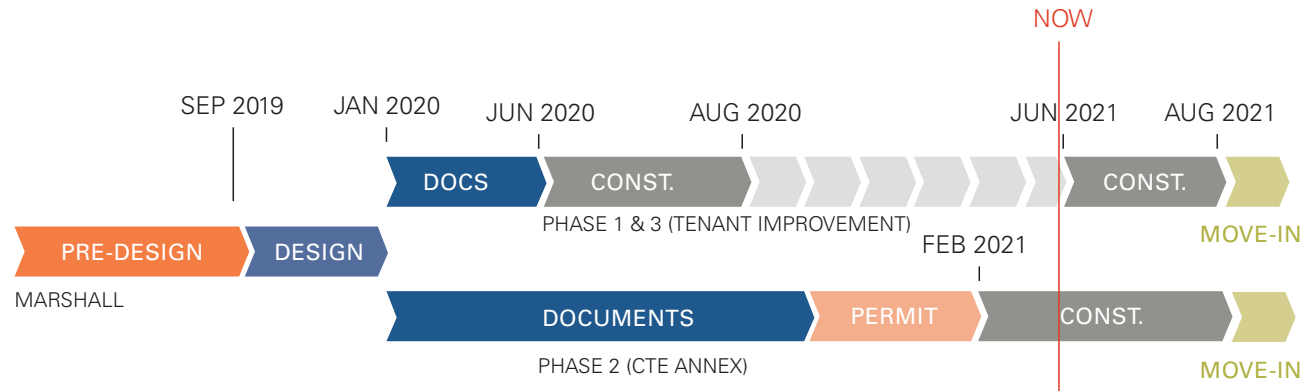

# MULTIPLE PATHWAYS TO GRADUATION / UPDATE

# MPG BUILDING SCHEDULE UPDATE

## DESIGN PROGRESS

- + Design Development wrapping up June 2021.
- + Path-to-Budget includes moving to a hybrid wood / steel structure
- + Additional VE to be incorporated

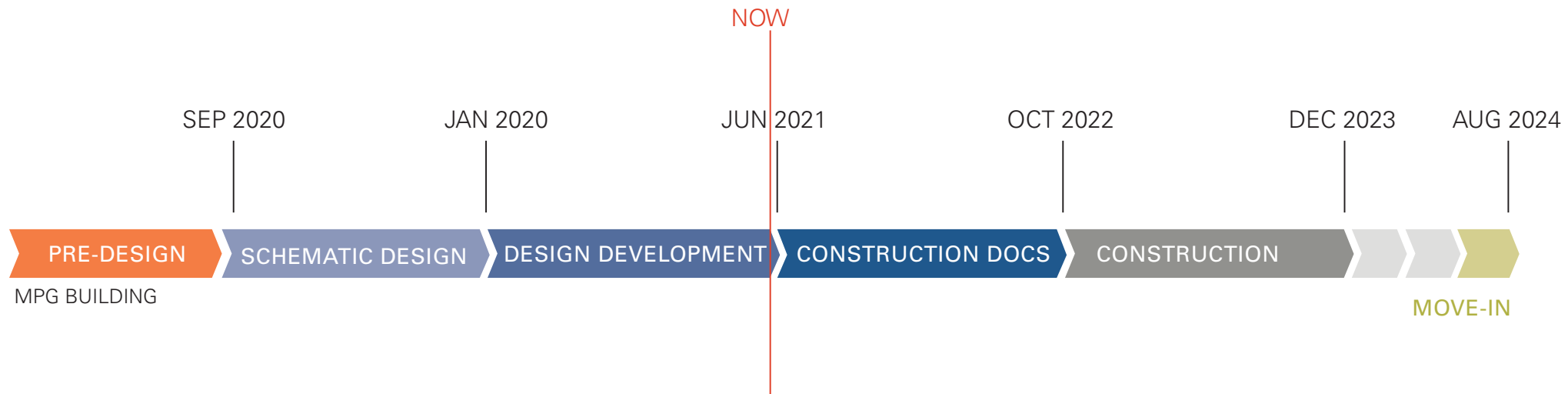



# MPG BUILDING / DESIGN UPDATE

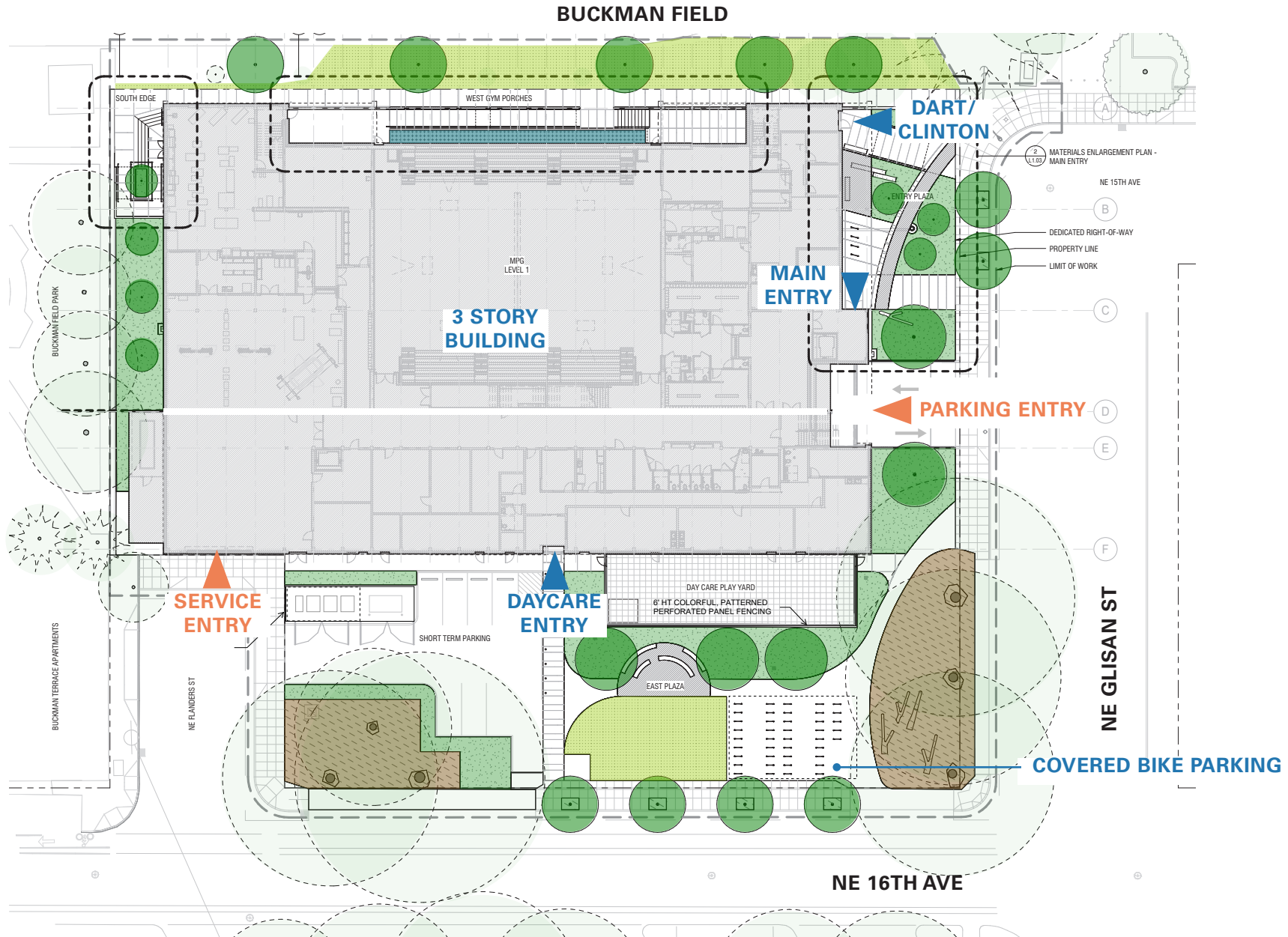

SITE PLAN

# MPG BUILDING / DESIGN UPDATE



VIEW FROM BUCKMAN FIELD FROM SW



# MPG BUILDING / DESIGN UPDATE



VIEW FROM 16TH AVE LOOKING TOWARD W / NW

QUESTIONS OR COMMENTS?

THANK YOU FOR YOUR CONTINUED SUPPORT!